

System Overview

Deck:	Standing Seam or Corrugated Metal Roof
Base Sheet:	None
Asphalt Emulsion:	30 Gal
Fiberglass Roving:	16 Lbs
Coating:	CA Title 24 Cool Roof Reflective Coating (3 Gal. / 100 Sq.Ft.)

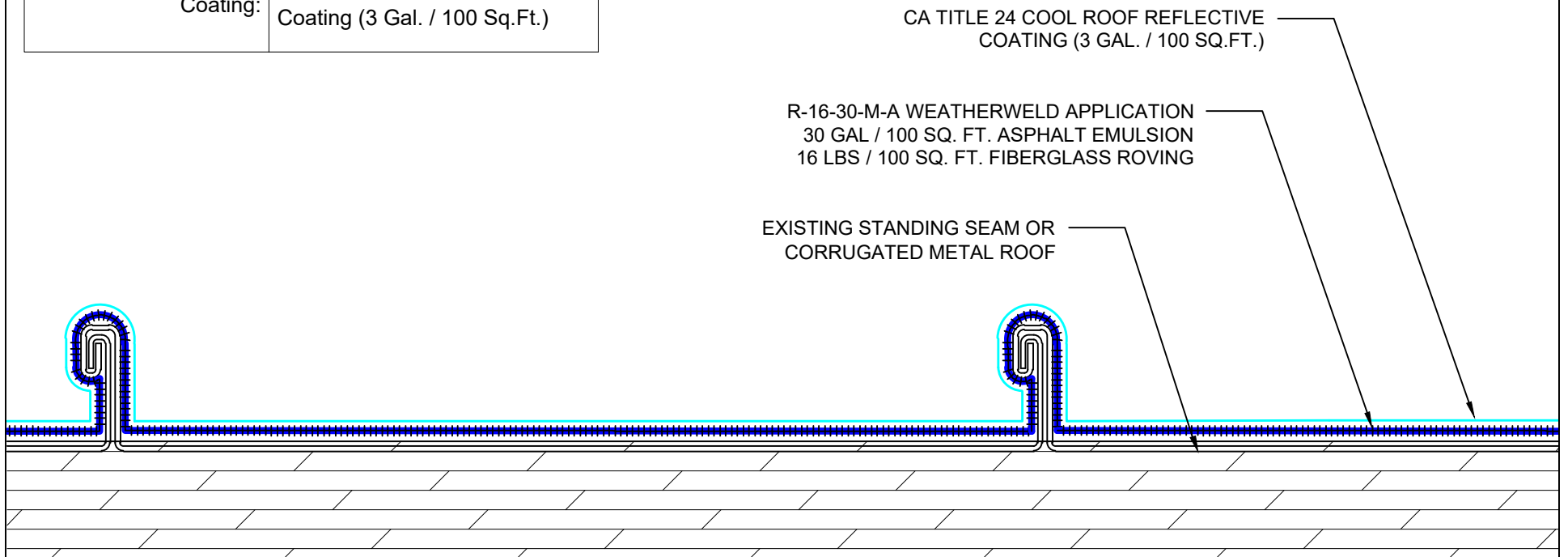

SYSTEM:

R-16-30-M-A



A DIVISION OF LIQUIFORM TECHNOLOGIES, INC.

9757 7th Street
 Suite 803
 Rancho Cucamonga, CA 91730-5297
 (888) 440-3224
 www.weatherweld.com

PREPARED FOR:

DRAWING TITLE:

SYSTEM OVERVIEW

DESIGNED BY:

DRAWN BY:

CHECKED BY:

DATE:

11/11/20

SCALE:

NTS

System Overview

Deck:	Standing Seam or Corrugated Metal Roof
Base Sheet:	None
Asphalt Emulsion:	30 Gal
Fiberglass Roving:	16 Lbs
Coating:	CA Title 24 Cool Roof Reflective Coating (3 Gal. / 100 Sq.Ft.)

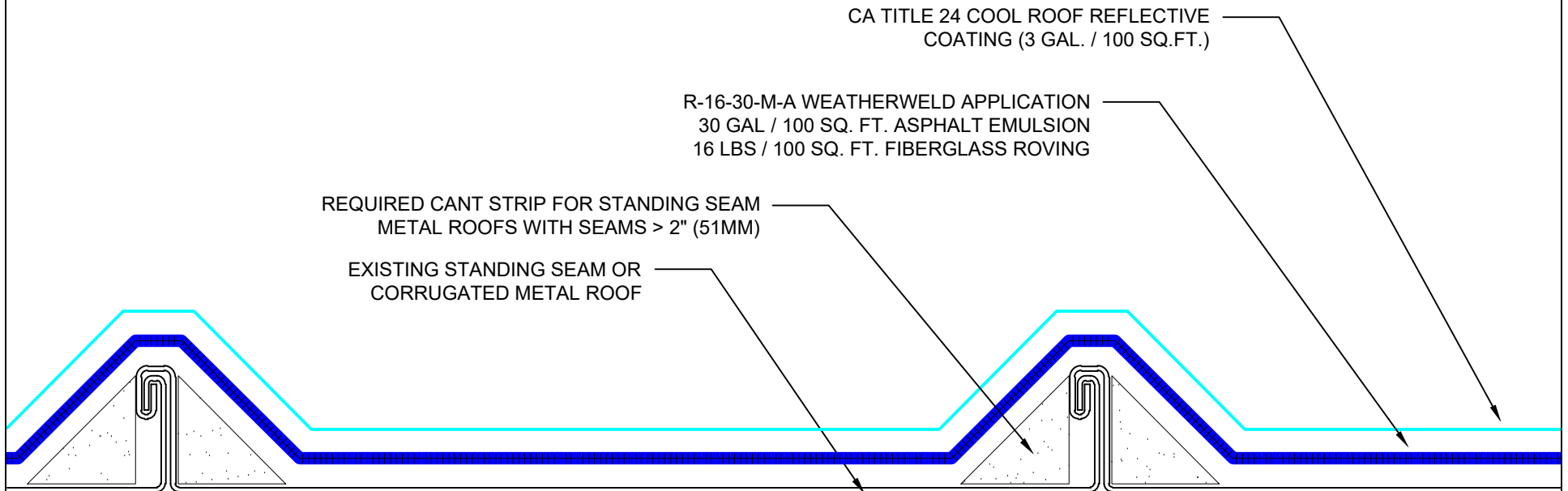

SYSTEM:

R-16-30-M-A

WEATHERWELD

A DIVISION OF LIQUIFORM TECHNOLOGIES, INC.

9757 7th Street
Suite 803
Rancho Cucamonga, CA 91730-5297
(888) 440-3224
www.weatherweld.com

PREPARED FOR:

DRAWING TITLE:

SYSTEM OVERVIEW (ALT)

DESIGNED BY:

DRAWN BY:

CHECKED BY:

DATE:

11/11/20

SCALE:

NTS

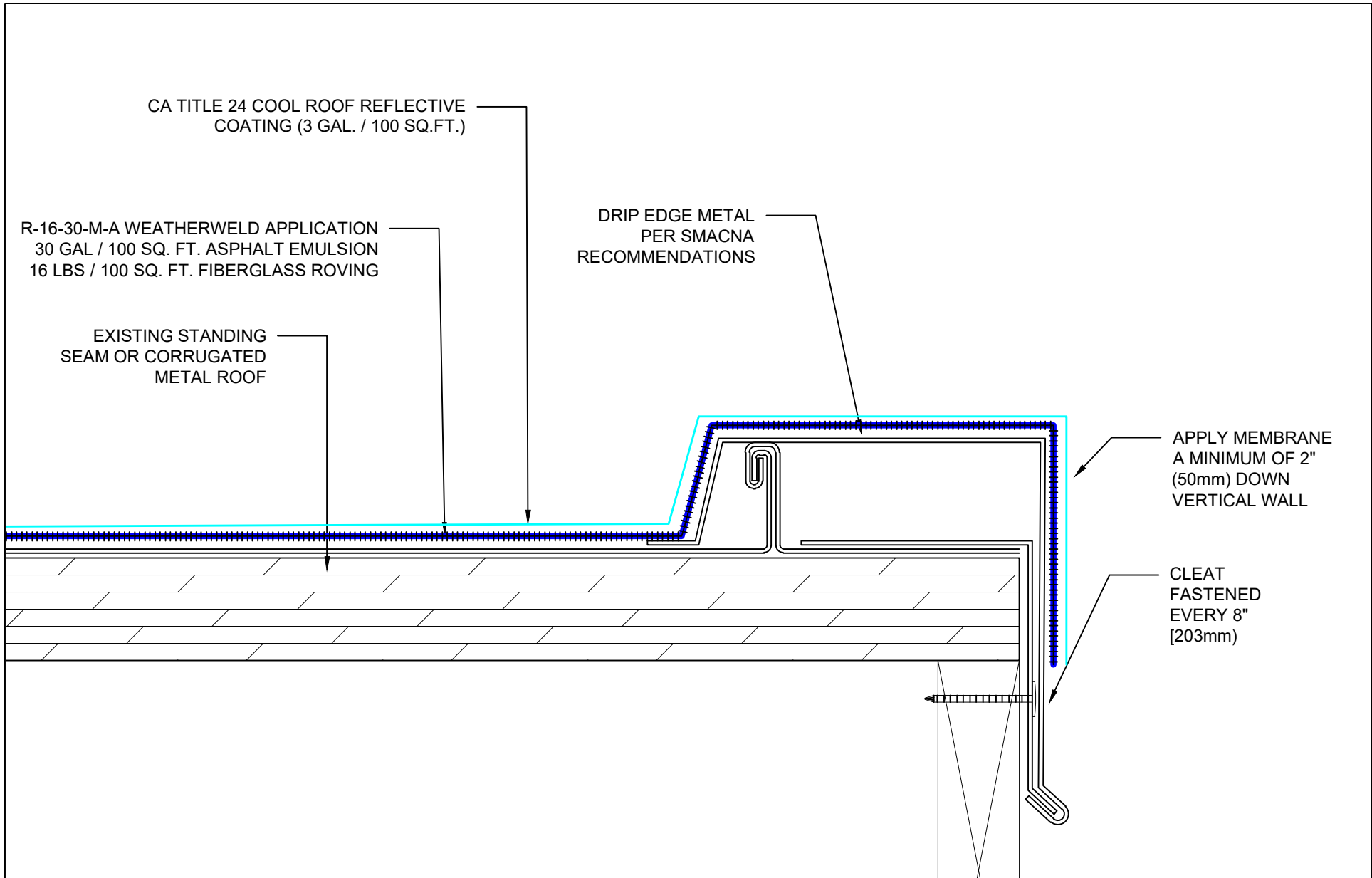

CA TITLE 24 COOL ROOF REFLECTIVE COATING (3 GAL. / 100 SQ.FT.)

R-16-30-M-A WEATHERWELD APPLICATION
30 GAL / 100 SQ. FT. ASPHALT EMULSION
16 LBS / 100 SQ. FT. FIBERGLASS ROVING

EXISTING STANDING SEAM OR CORRUGATED METAL ROOF

DRIP EDGE METAL PER SMACNA RECOMMENDATIONS

APPLY MEMBRANE A MINIMUM OF 2" (50mm) DOWN VERTICAL WALL

CLEAT FASTENED EVERY 8" [203mm]

SYSTEM:

R-16-30-M-A

WEATHERWELD

A DIVISION OF LIQUIFORM TECHNOLOGIES, INC.

9757 7th Street
Suite 803
Rancho Cucamonga, CA 91730-5297
(888) 440-3224
www.weatherweld.com

PREPARED FOR:

DRAWING TITLE:
EDGE FLASHING

DESIGNED BY:

DRAWN BY:

CHECKED BY:

DATE:
11/11/20

SCALE:
NTS

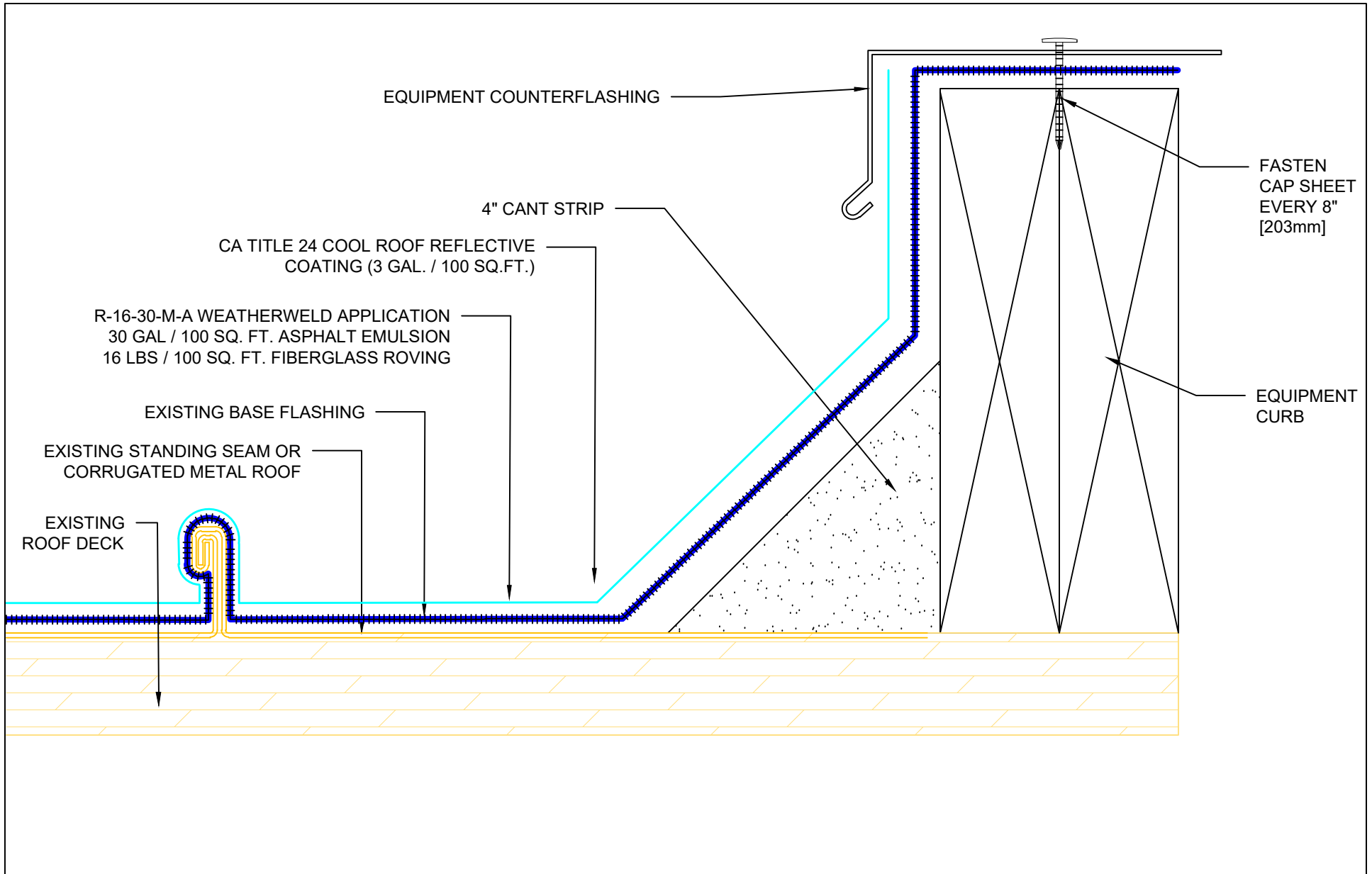

<p>SYSTEM:</p> <p>R-16-30-M-A</p>	<p>WEATHERWELD A DIVISION OF LIQUIFORM TECHNOLOGIES, INC.</p> <p>9757 7th Street Suite 803 Rancho Cucamonga, CA 91730-5297 (888) 440-3224 www.weatherweld.com</p>	<p>PREPARED FOR:</p>			
<p>DRAWING TITLE: EQUIPMENT PAD FLASHING</p>	<p>DESIGNED BY:</p>	<p>DRAWN BY:</p>	<p>CHECKED BY:</p>	<p>DATE: 11/11/20</p>	<p>SCALE: NTS</p>

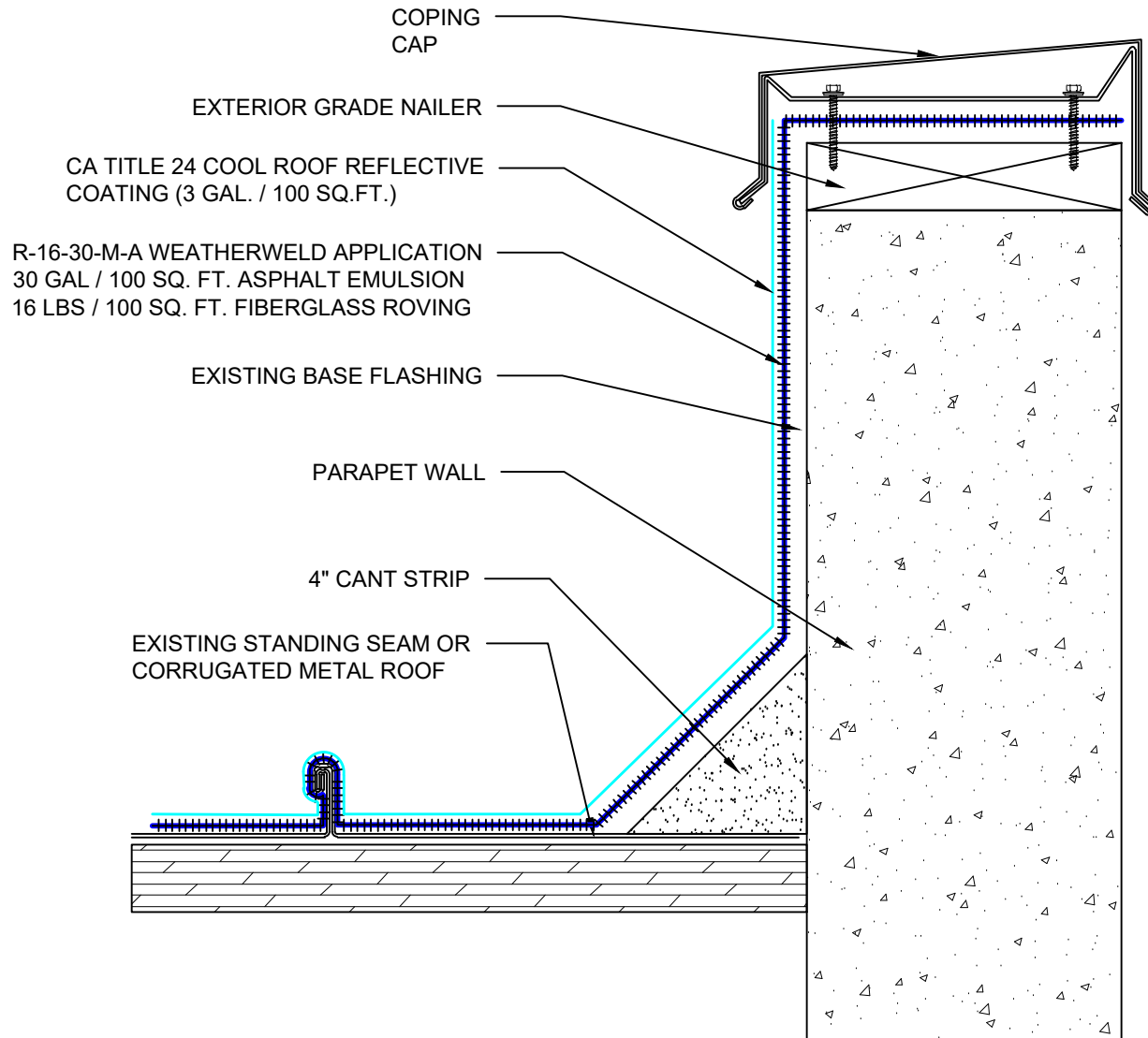

SYSTEM:

R-16-30-M-A

WEATHERWELD

A DIVISION OF LIQUIFORM TECHNOLOGIES, INC.

9757 7th Street
Suite 803
Rancho Cucamonga, CA 91730-5297
(888) 440-3224
www.weatherweld.com

PREPARED FOR:

DRAWING TITLE:

PARAPET WALL FLASHING

DESIGNED BY:

DRAWN BY:

CHECKED BY:

DATE:

11/11/20

SCALE:

NTS

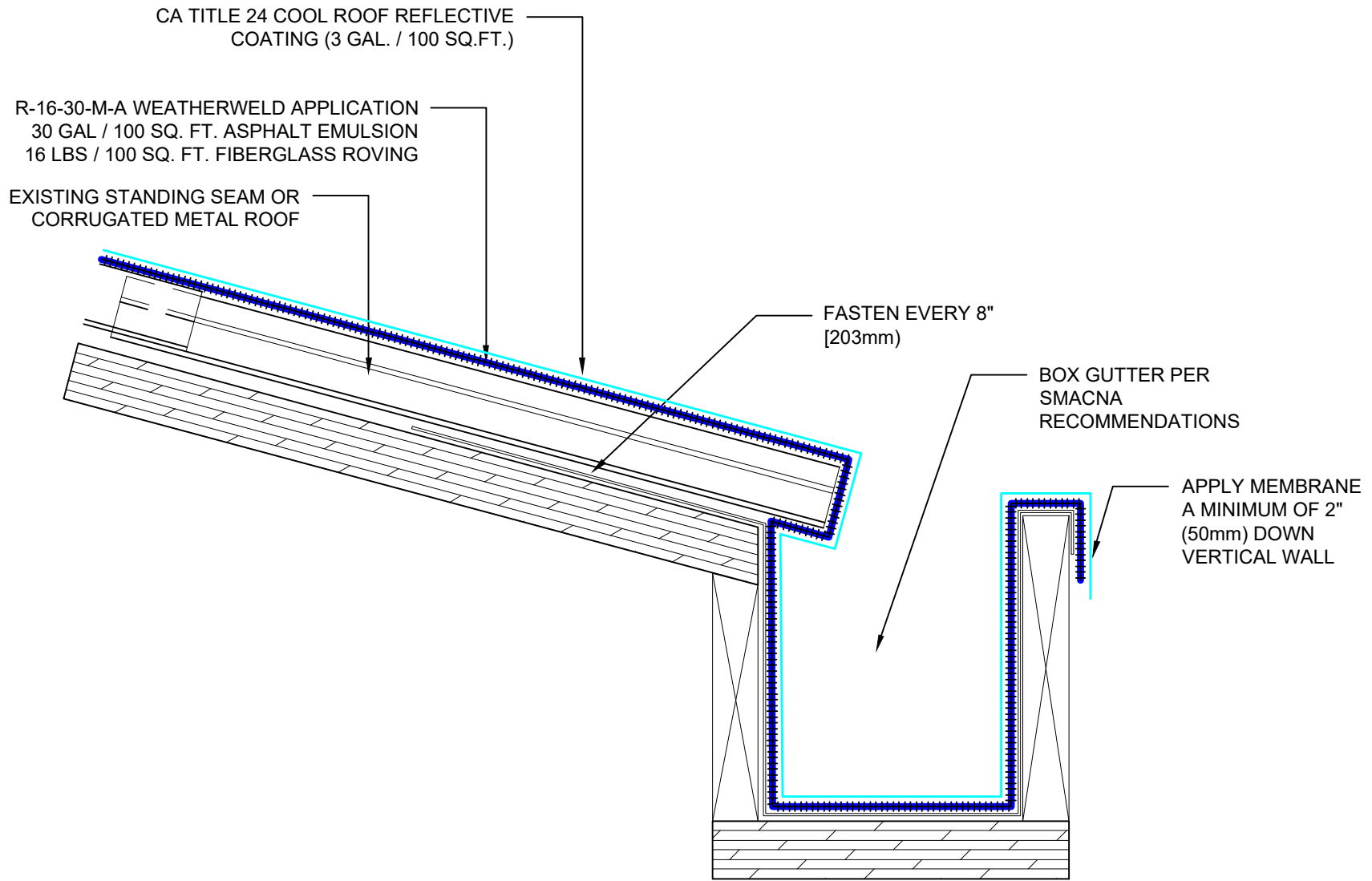

SYSTEM:

R-16-30-M-A



A DIVISION OF LIQUIFORM TECHNOLOGIES, INC.

9757 7th Street
Suite 803
Rancho Cucamonga, CA 91730-5297
(888) 440-3224
www.weatherweld.com

PREPARED FOR:

DRAWING TITLE:
BOX GUTTER

DESIGNED BY:

DRAWN BY:

CHECKED BY:

DATE:
11/11/20

SCALE:
NTS

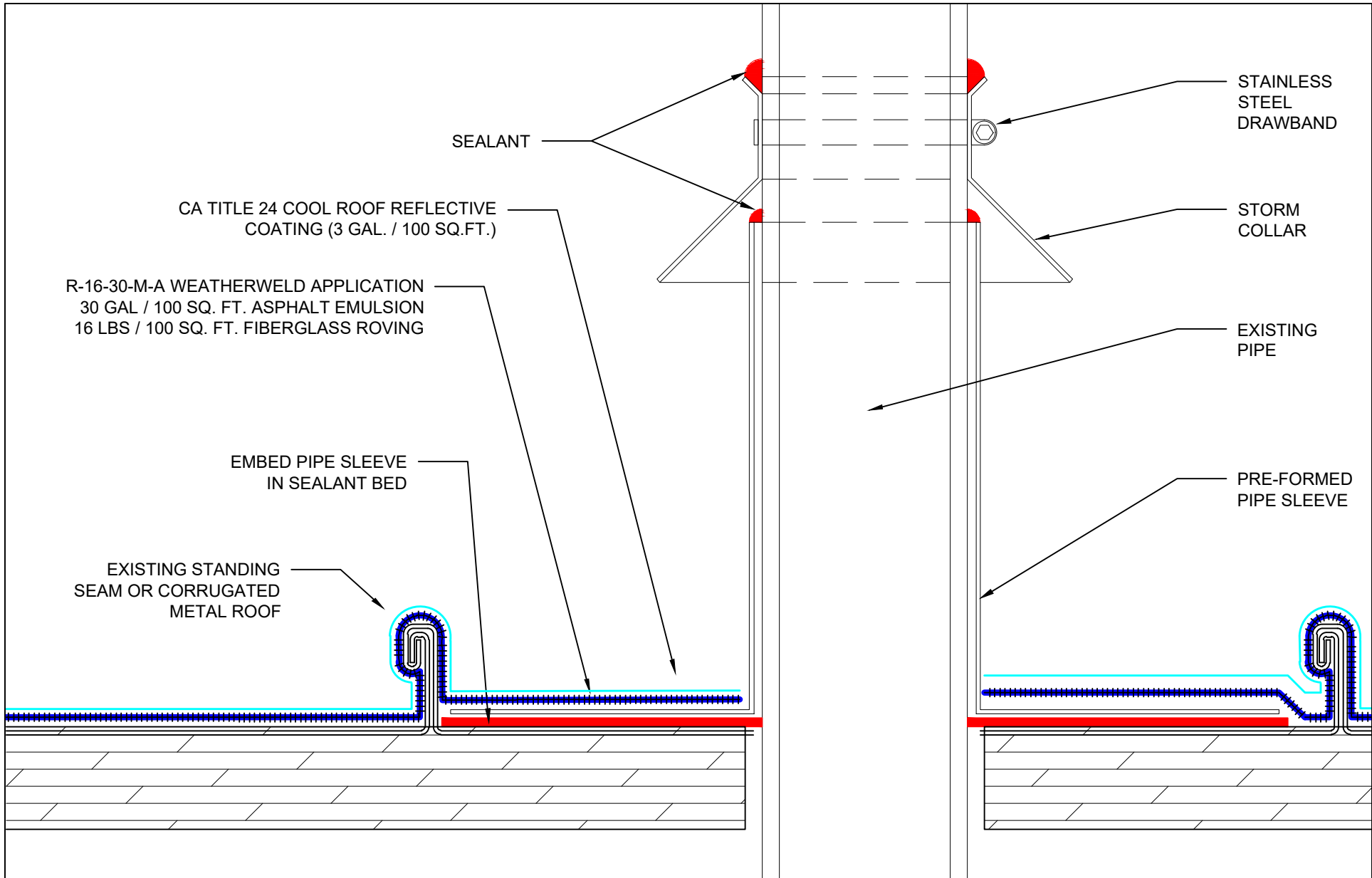

SYSTEM:
R-16-30-M-A

WEATHERWELD
A DIVISION OF LIQUIFORM TECHNOLOGIES, INC.
9757 7th Street
Suite 803
Rancho Cucamonga, CA 91730-5297
(888) 440-3224
www.weatherweld.com

DRAWING TITLE:
PIPE FLASHING

PREPARED FOR:

DESIGNED BY: DRAWN BY: CHECKED BY: DATE: 11/11/20 SCALE: NTS