

System Overview

Deck:	Nailable Roof Deck
Base Sheet:	80# Granule Surfaced Cap Sheet (Inverted)
Asphalt Emulsion:	30 Gal
Fiberglass Roving:	16 Lbs
Coating:	CA Title 24 Cool Roof Reflective Coating (3 Gal. / 100 Sq.Ft.)

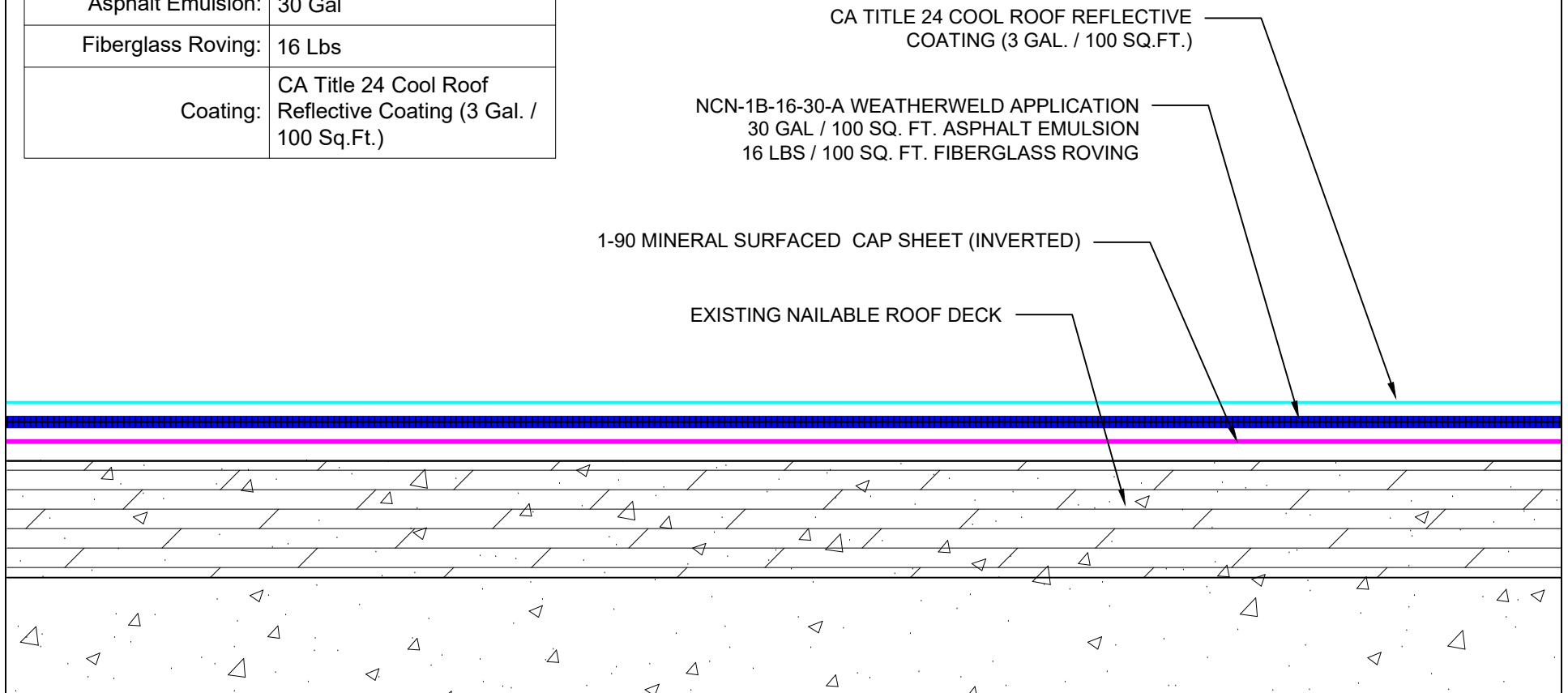

SYSTEM:
NCN-1B-16-30-A



9757 7th Street
Suite 803
Rancho Cucamonga, CA 91730-5297
(888) 440-3224
www.weatherweld.com

PREPARED FOR:				
DRAWING TITLE: SYSTEM OVERVIEW	DESIGNED BY:	DRAWN BY:	CHECKED BY:	DATE: 11/10/20
				SCALE: NTS

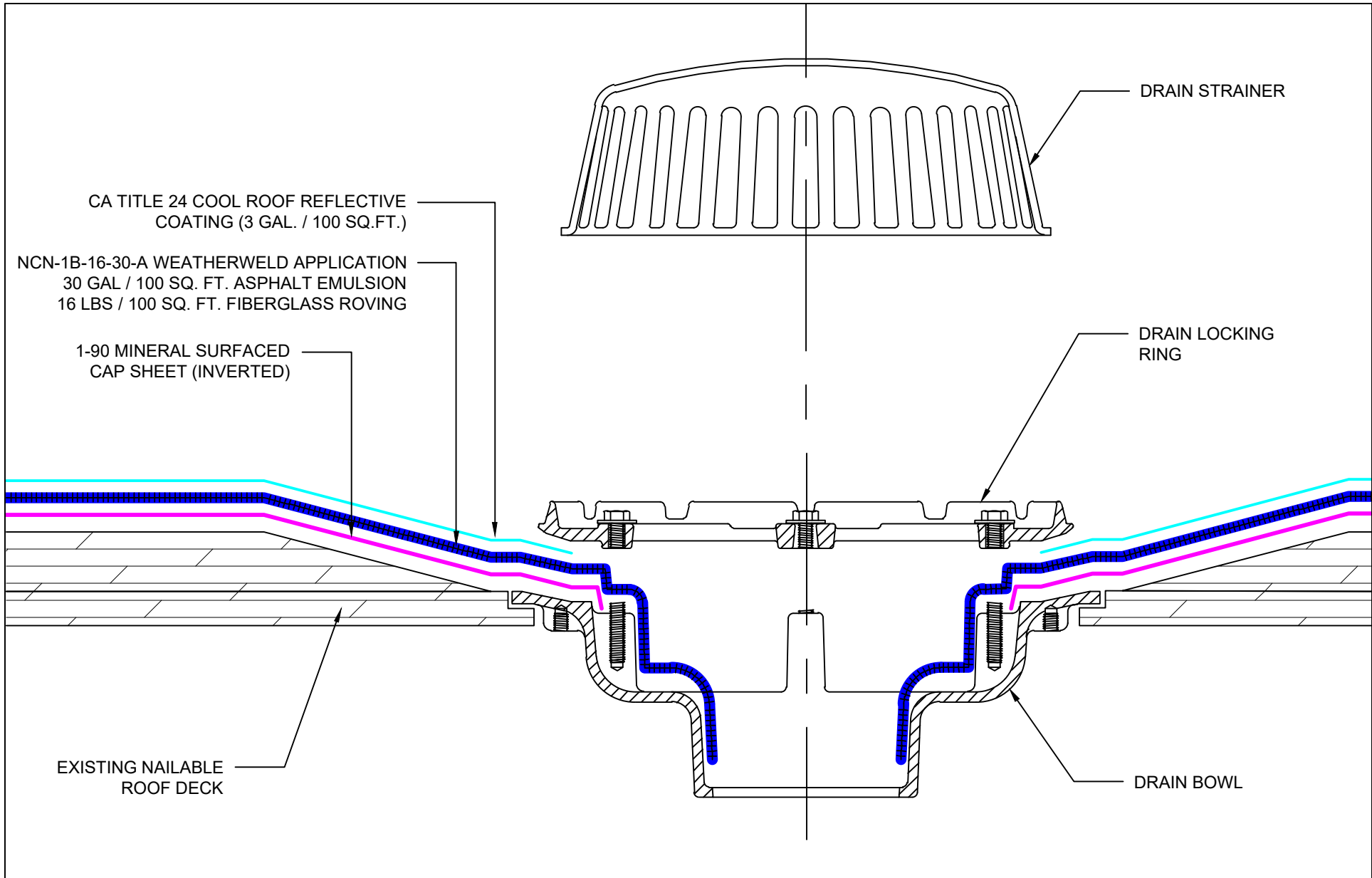

<p>SYSTEM:</p> <p>NCN-1B-16-30-A</p>	<p>WEATHERWELD <small>A DIVISION OF LIQUIFORM TECHNOLOGIES, INC.</small></p> <p>9757 7th Street Suite 803 Rancho Cucamonga, CA 91730-5297 (888) 440-3224 www.weatherweld.com</p>	<p>PREPARED FOR:</p>			
<p>DRAWING TITLE: DRAIN DETAIL</p>	<p>DESIGNED BY:</p>	<p>DRAWN BY:</p>	<p>CHECKED BY:</p>	<p>DATE: 11/10/20</p>	<p>SCALE: NTS</p>

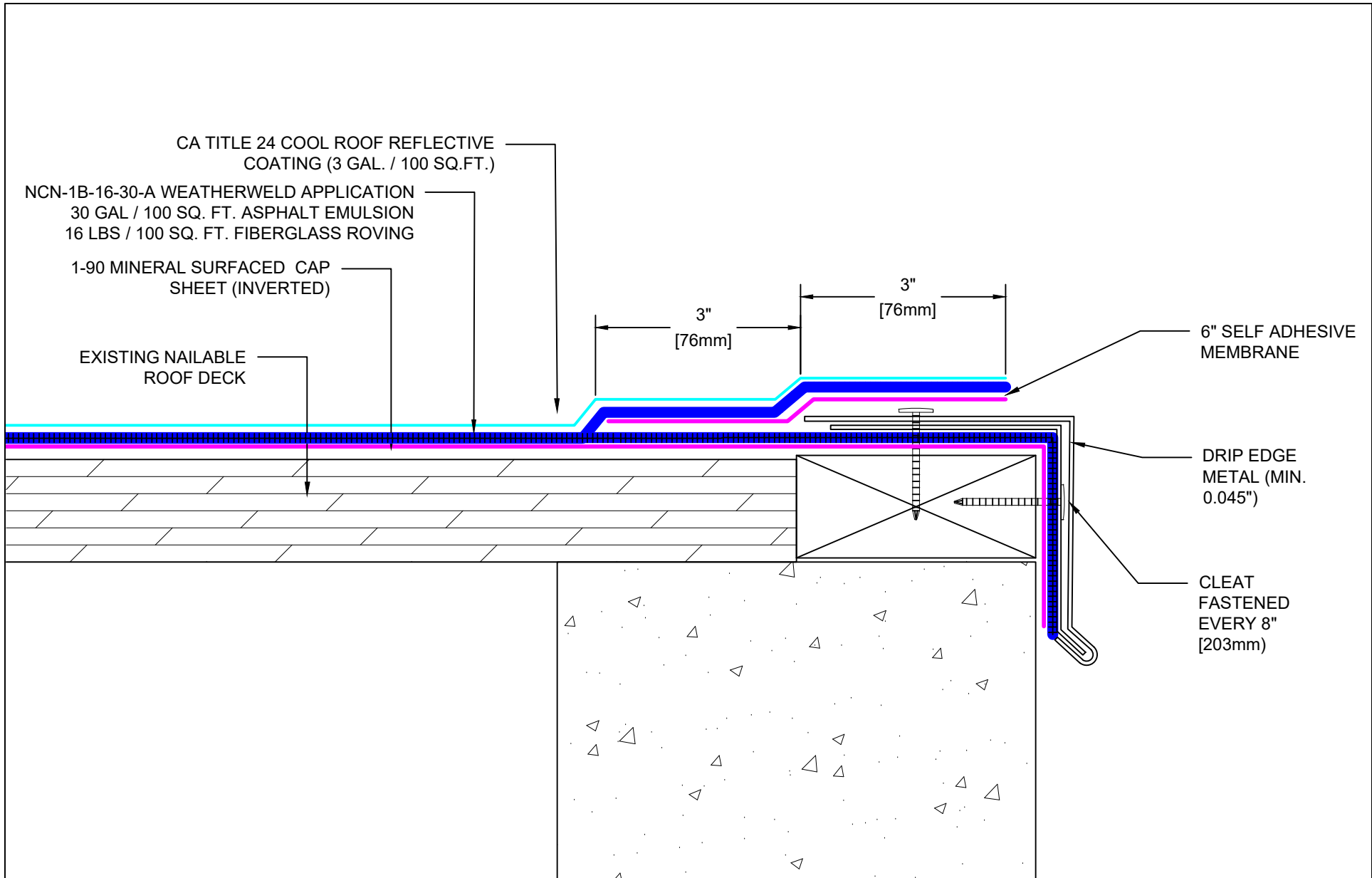

<p>SYSTEM:</p> <p>NCN-1B-16-30-A</p>	<p>WEATHERWELD <small>A DIVISION OF LIQUIFORM TECHNOLOGIES, INC.</small></p> <p>9757 7th Street Suite 803 Rancho Cucamonga, CA 91730-5297 (888) 440-3224 www.weatherweld.com</p>	<p>PREPARED FOR:</p>			
<p>DRAWING TITLE: EDGE FLASHING</p>	<p>DESIGNED BY:</p>	<p>DRAWN BY:</p>	<p>CHECKED BY:</p>	<p>DATE: 11/10/20</p>	<p>SCALE: NTS</p>

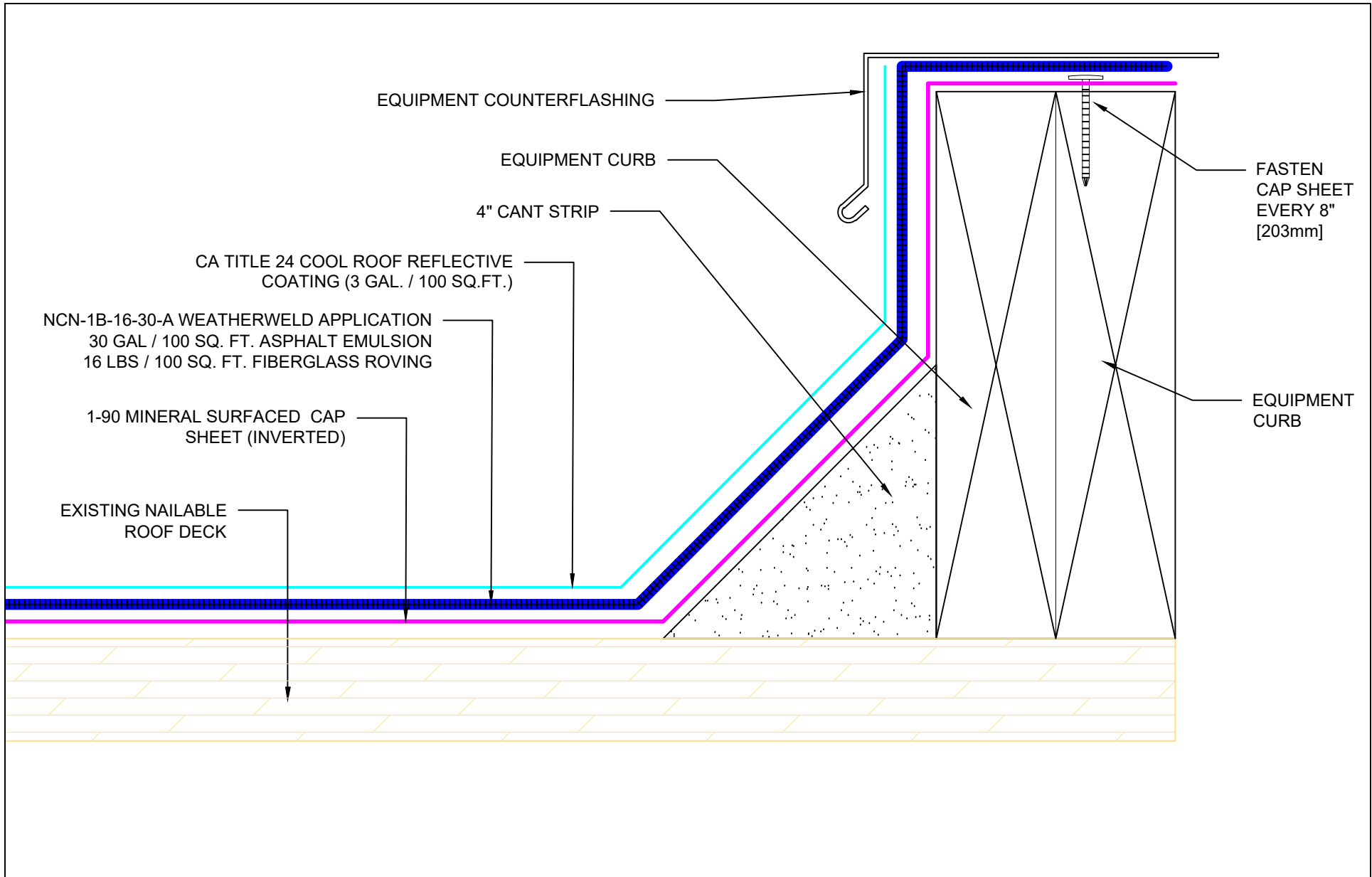

<p>SYSTEM:</p> <p>NCN-1B-16-30-A</p>	<p>WEATHERWELD <small>A DIVISION OF LIQUIFORM TECHNOLOGIES, INC.</small></p> <p>9757 7th Street Suite 803 Rancho Cucamonga, CA 91730-5297 (888) 440-3224 www.weatherweld.com</p>	<p>PREPARED FOR:</p>			
<p>DRAWING TITLE: EQUIPMENT PAD FLASHING</p>	<p>DESIGNED BY:</p>	<p>DRAWN BY:</p>	<p>CHECKED BY:</p>	<p>DATE: 11/10/20</p>	<p>SCALE: NTS</p>

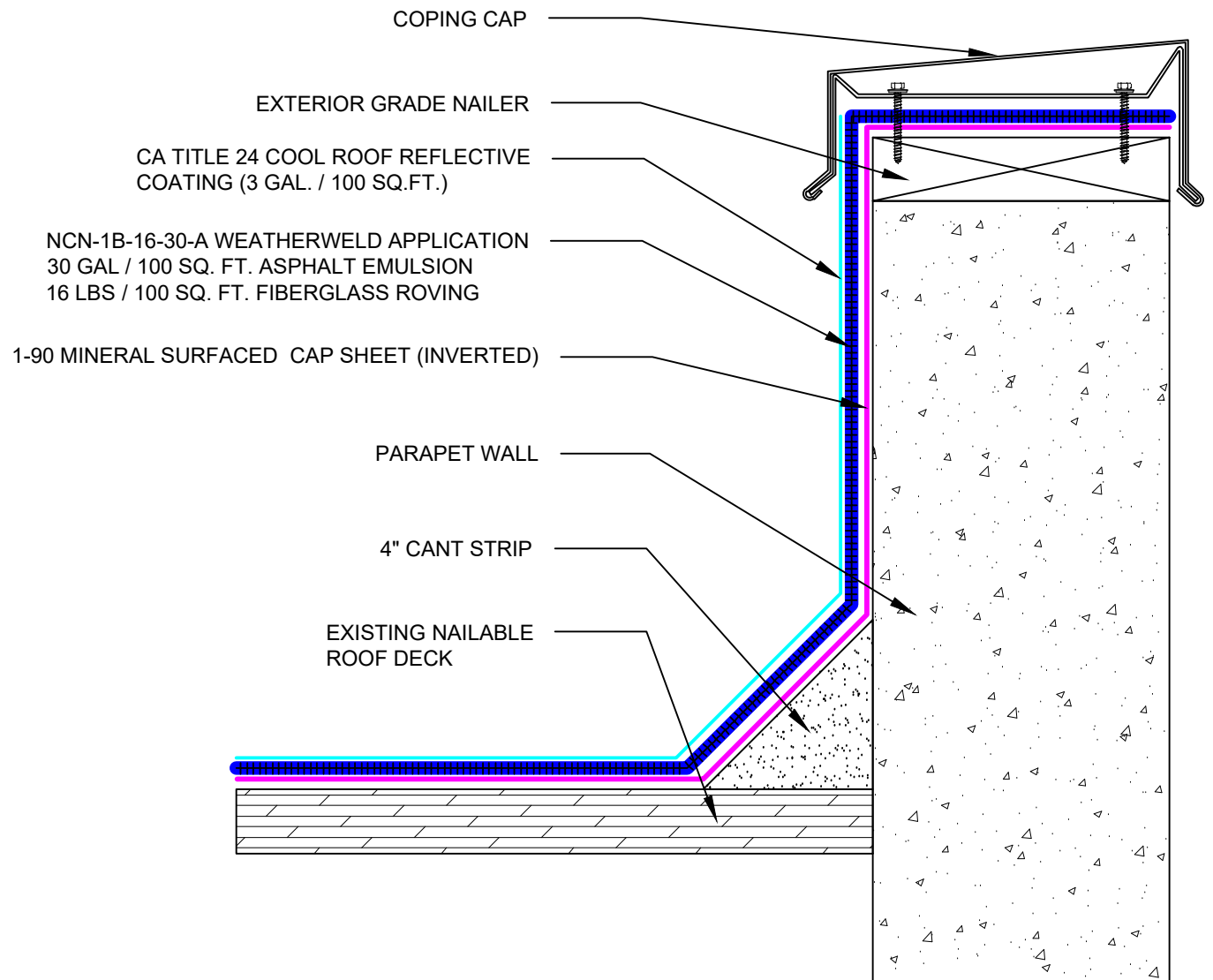

COPING CAP

EXTERIOR GRADE NAILER

CA TITLE 24 COOL ROOF REFLECTIVE COATING (3 GAL. / 100 SQ.FT.)

NCN-1B-16-30-A WEATHERWELD APPLICATION
30 GAL / 100 SQ. FT. ASPHALT EMULSION
16 LBS / 100 SQ. FT. FIBERGLASS ROVING

1-90 MINERAL SURFACED CAP SHEET (INVERTED)

PARAPET WALL

4" CANT STRIP

EXISTING NAILABLE ROOF DECK

<p>SYSTEM:</p> <p>NCN-1B-16-30-A</p>	<p>WEATHERWELD A DIVISION OF LIQUIFORM TECHNOLOGIES, INC.</p> <p>9757 7th Street Suite 803 Rancho Cucamonga, CA 91730-5297 (888) 440-3224 www.weatherweld.com</p>	<p>PREPARED FOR:</p>			
<p>DRAWING TITLE: PARAPET WALL FLASHING</p>	<p>DESIGNED BY:</p>	<p>DRAWN BY:</p>	<p>CHECKED BY:</p>	<p>DATE: 11/10/20</p>	<p>SCALE: NTS</p>

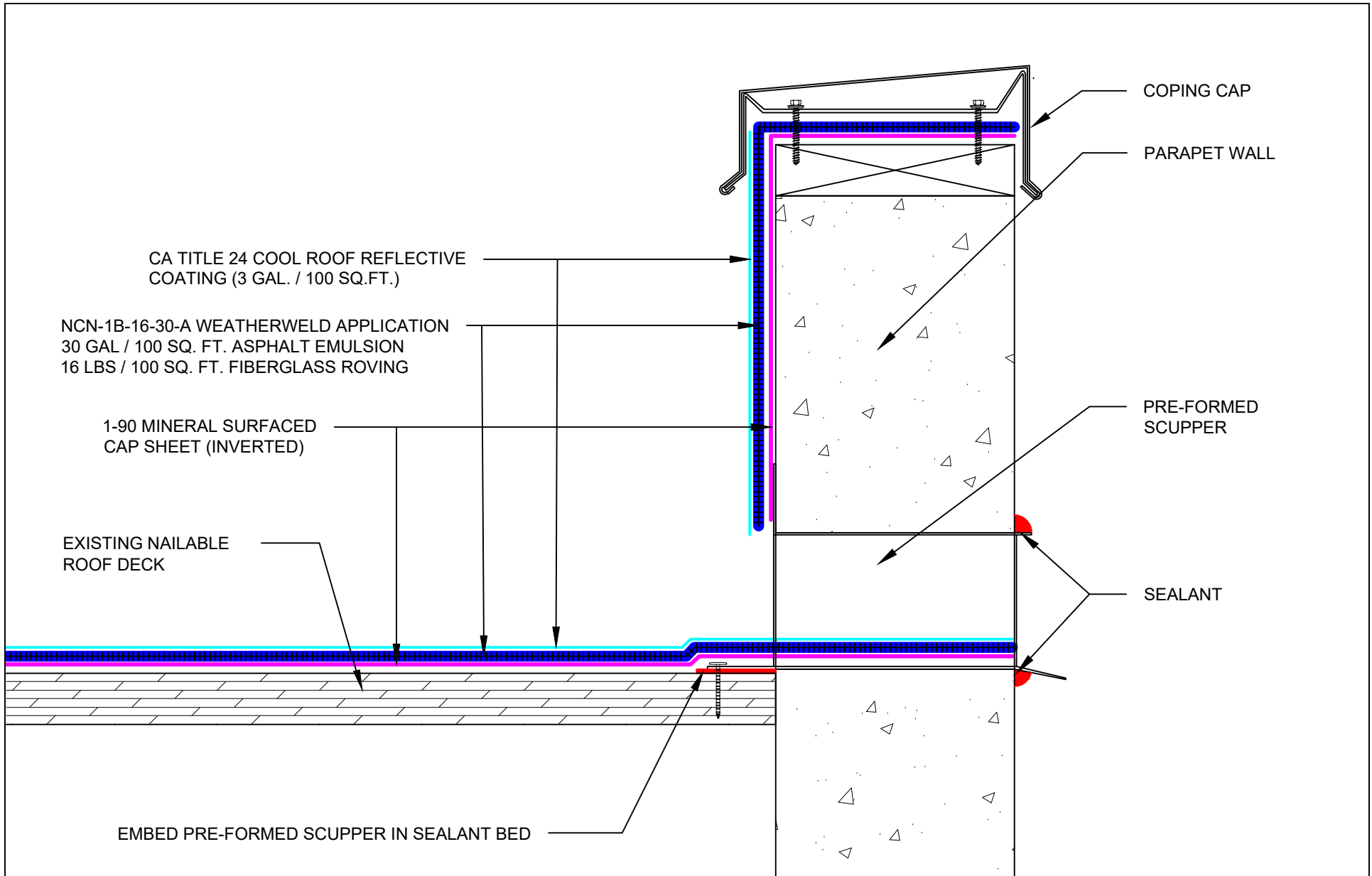

<p>SYSTEM:</p> <p>NCN-1B-16-30-A</p>	<p>WEATHERWELD A DIVISION OF LIQUIFORM TECHNOLOGIES, INC.</p> <p>9757 7th Street Suite 803 Rancho Cucamonga, CA 91730-5297 (888) 440-3224 www.weatherweld.com</p>	<p>PREPARED FOR:</p>			
<p>DRAWING TITLE: SCUPPER FLASHING</p>	<p>DESIGNED BY:</p>	<p>DRAWN BY:</p>	<p>CHECKED BY:</p>	<p>DATE: 11/10/20</p>	<p>SCALE: NTS</p>

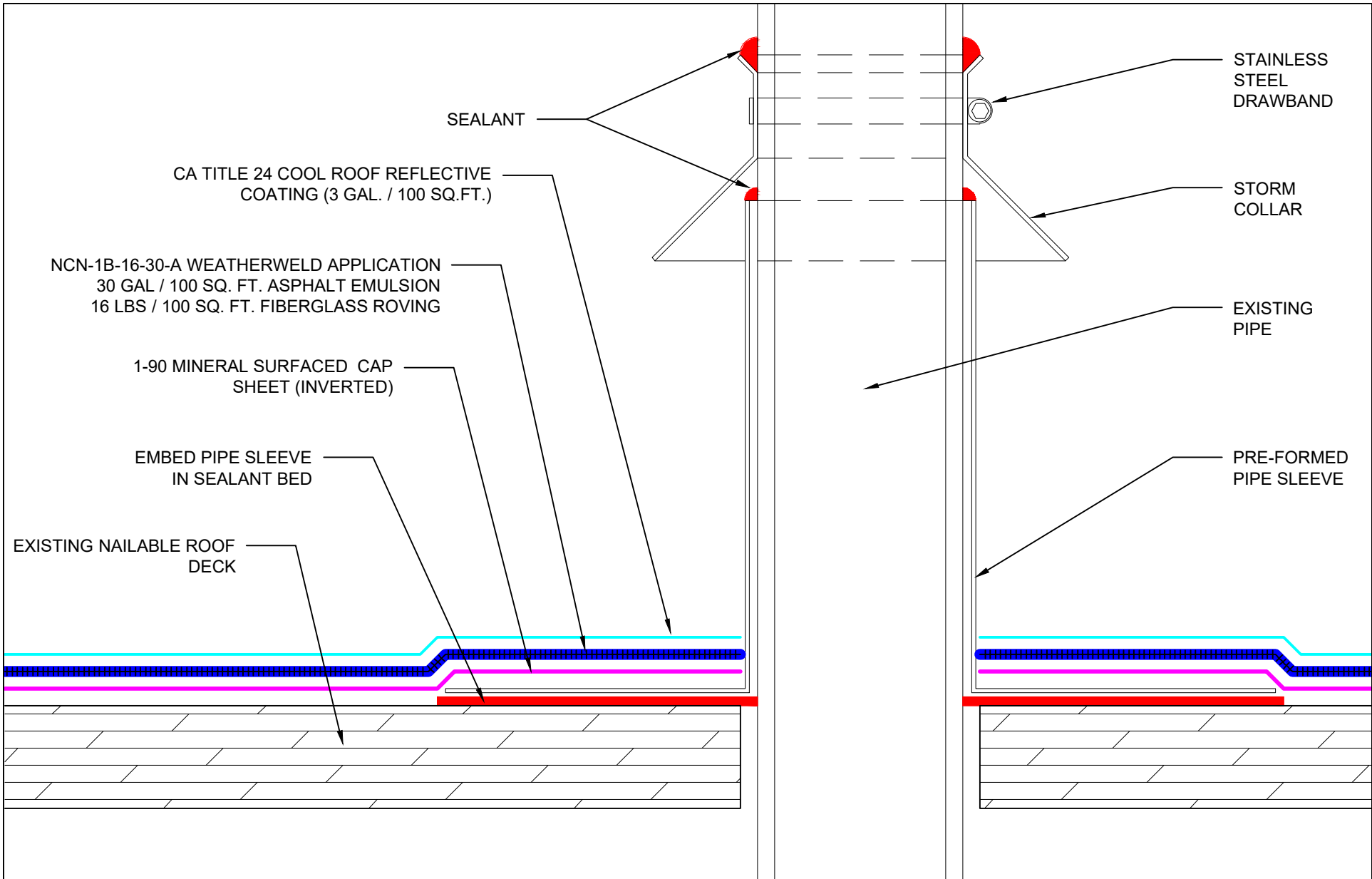

SEALANT

CA TITLE 24 COOL ROOF REFLECTIVE COATING (3 GAL. / 100 SQ.FT.)

NCN-1B-16-30-A WEATHERWELD APPLICATION
30 GAL / 100 SQ. FT. ASPHALT EMULSION
16 LBS / 100 SQ. FT. FIBERGLASS ROVING

1-90 MINERAL SURFACED CAP SHEET (INVERTED)

EMBED PIPE SLEEVE IN SEALANT BED

EXISTING NAILABLE ROOF DECK

STAINLESS STEEL DRAWBAND

STORM COLLAR

EXISTING PIPE

PRE-FORMED PIPE SLEEVE

SYSTEM:

NCN-1B-16-30-A



A DIVISION OF LIQUIFORM TECHNOLOGIES, INC.

9757 7th Street
Suite 803
Rancho Cucamonga, CA 91730-5297
(888) 440-3224
www.weatherweld.com

PREPARED FOR:

DRAWING TITLE:
PIPE FLASHING

DESIGNED BY:

DRAWN BY:

CHECKED BY:

DATE:
11/10/20

SCALE:
NTS